

TORQUE CONTROL & MULTIPLIERS

- Torque Wrench
- Interchangeable Torque Wrench & Accessory
- Electronic Torque Adapter
- Torque Screwdriver
- Torque Angle Gauge & Multiplier
- Torque Tester

Calibration Instruction And Reminder of Torque Wrench

In test conditions, the torque wrench should remain within the tolerances laid down by DIN ISO 6789:2017 & ASME B107.300-2010 for 5000 cycles. Practically, this may be affected and changed by ingress of dust, causing wear, or by damage caused by using the tool improperly such as to loosen fasteners or being dropped regularly.

Assuming the users are trained to use the torque wrenches, and follow the provided comments of instruction, a period of twelve months is reasonable for torque wrenches used in non safety critical areas.

For those tools used in critical applications, a three month or even monthly check would be suggested.

Set Point	Meas.	Max.	Min.	Settings
100	100	100	100	100
200	200	200	200	200
300	300	300	300	300
400	400	400	400	400
500	500	500	500	500
600	600	600	600	600
700	700	700	700	700
800	800	800	800	800
900	900	900	900	900
1000	1000	1000	1000	1000

Calibration Certificate

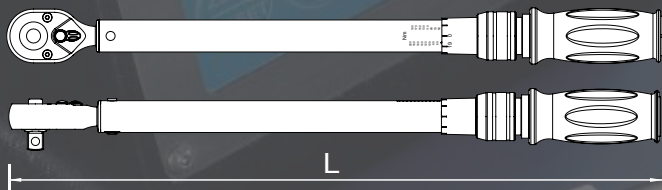

1 Nm = 0.738 ft.lb. = 0.102 kgf.m
 1 ft.lb. = 1.356 Nm = 0.138 kgf.m
 1 in.lb. = 0.113 Nm = 1.152 kgf.cm

Recyclable cylindrical package

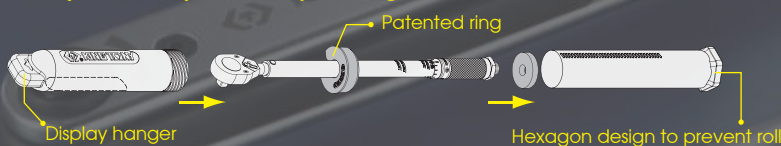



Master Torque Control

62 SERIES

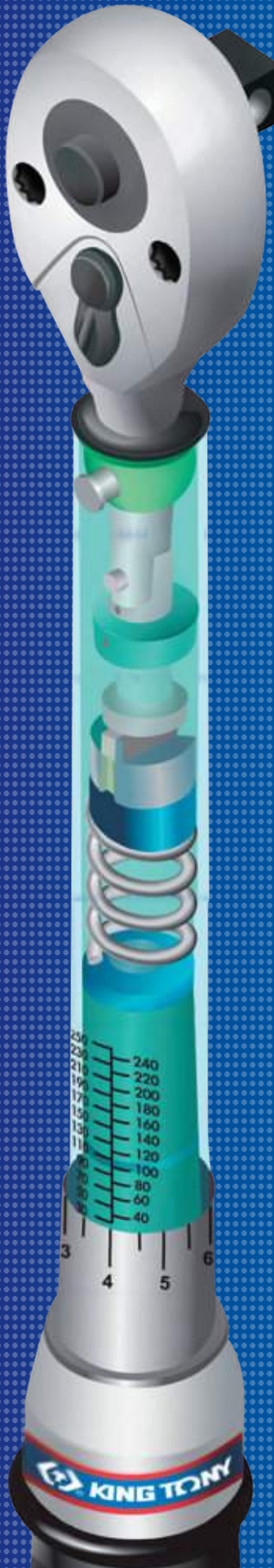

Quick:

- Quick release and fine tooth gears design increases efficiency for safety tightening



Sound:

- Click sound and vibration reminds operator to stop in correct torque



Lubricant:

- Apply top industrial level lubricant to reduce friction and keep performance in good condition much longer



Spring:

- Made of high quality alloy steel to offer extended working cycles



Frame:

- Hardened tube provides extreme durability against friction to assure precision of tolerance



Easy:

- Auto lock design of torque adjustment provides quick and comfortable working experience

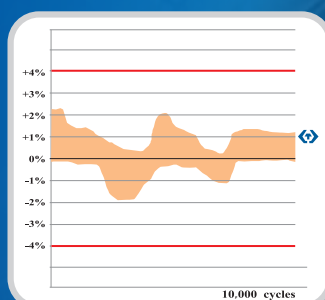

- **±3% tolerance of torque and 10,000 cycles durability performs better than international standard "DIN ISO 6789:2017 & ASME B107.300-2010" with ±4% tolerance and 5,000 cycles requirement.**

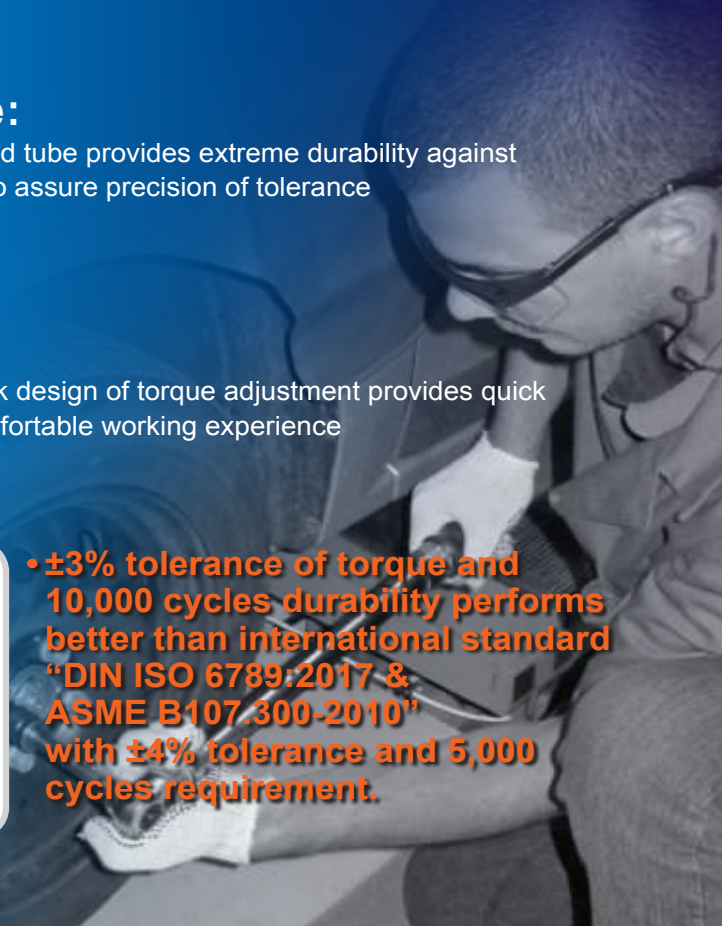

Heavy Duty Adjustable Torque Wrench

Design for easy torque adjustment

Quality accords to DIN ISO 6789:2017 & ASME B107.300-2010

Tolerance of torque $\pm 3\%$ (CW)

CW/CCW Direction

1 Nm = 0.738 ft.lb. = 0.102 kgf.m
 1 ft.lb. = 1.356 Nm = 0.138 kgf.m
 1 in.lb. = 0.113 Nm = 1.152 kgf.cm



Quick release



Wide range of choice distinct laser scale

Automatic quickly return adjustment

Comfortable rubber handle



Video QR Code

Dual Scale - English & Newton Meter (in.lb. / ft.lb. & Nm)

KT NO.	Gear teeth	Square drive	Torque range in. lb. / ft. lb.	Incr.	Torque range Nm	Incr.	Overall length mm		
34262-1CG	24	1/4"	40~200 in.lb.	1 in.lb.	5.1~22.0 Nm	0.12 Nm	324	640	1 / 12
34362-1CG	24	3/8"	40~200 in.lb.	1 in.lb.	5.1~22.0 Nm	0.12 Nm	324	640	1 / 12
34362-2CG	32	3/8"	15~80 ft.lb.	0.5 ft.lb.	23.7~105.1 Nm	0.7 Nm	435	1300	1 / 12
34462-1CG	32	1/2"	20~150 ft.lb.	1 ft.lb.	34~197 Nm	1.4 Nm	521	1590	1 / 12
34462-2CG	32	1/2"	50~250 ft.lb.	1 ft.lb.	75~332 Nm	1.4 Nm	613	1810	1 / 12
34662-1CG	24	3/4"	100~450 ft.lb.	5 ft.lb.	169~576 Nm	6.8 Nm	1048	5500	1 / 2
34662-2CG	24	3/4"	100~600 ft.lb.	5 ft.lb.	169~779 Nm	6.8 Nm	1234	5600	1 / 2
34662-3CG	24	3/4"	150~750 ft.lb.	5 ft.lb.	237~983 Nm	6.8 Nm	1238	6150	1 / 2
34862-1CG	24	1"	150~750 ft.lb.	5 ft.lb.	237~983 Nm	6.8 Nm	1238	6150	1 / 2

Single scale - Newton Meter (Nm)

KT NO.	Gear teeth	Square drive	Torque range Nm	Incr.	Overall length mm		
34262-1DG	24	1/4"	4~20 Nm	0.1 Nm	324	640	1 / 12
34262-2DG	24	1/4"	2~10 Nm	0.1 Nm	281	560	1 / 12
34262-3DG	24	1/4"	5~30 Nm	0.5 Nm	325	640	1 / 12
34362-1DG	24	3/8"	4~20 Nm	0.1 Nm	324	640	1 / 12
34362-2DG	32	3/8"	20~100 Nm	0.5 Nm	435	1300	1 / 12
34362-3DG	32	3/8"	10~60 Nm	0.5 Nm	325	1300	1 / 12
34462-1DG	32	1/2"	40~200 Nm	1 Nm	521	1590	1 / 12
34462-2DG	32	1/2"	60~340 Nm	2 Nm	613	1810	1 / 12
34462-3DG	32	1/2"	20~100 Nm	1 Nm	436	1300	1 / 12
34462-4DG	32	1/2"	80~400 Nm	2 Nm	613	1970	1 / 12
34662-1DG	24	3/4"	100~600 Nm	5 Nm	1048	5500	1 / 2
34662-2DG	24	3/4"	150~800 Nm	5 Nm	1234	5600	1 / 2
34662-3DG	24	3/4"	200~1000 Nm	5 Nm	1238	6150	1 / 2
34862-1DG	24	1"	200~1000 Nm	5 Nm	1238	6150	1 / 2



1. Do not use this torque wrench over its scale range.
 2. Do not use this torque wrench as a normal hand tool.
 3. Torque wrench need to be calibrated periodically for accuracy.

CAUTION

- 34262-1DK
- 34362-1DK
- 34362-2DK: 34362-2xx / 3xx
- 34462-1DK
- 34462-3DK: 34462-3DG / 3GG
- 34662-1DK
- 34662-3DK1: 34662-3xxx series No. after 0805xxxx
- 34862-1DK: series No. before 0805xxxx
- 34862-2DK: series No. after 0805xxxx



Single scale - English (in.lb./ft.lb.)

KT NO.	Gear teeth	Square drive	Torque range in. lb. / ft. lb.	Incr.	Overall length mm		
34262-1EG	24	1/4"	40~200 in.lb.	1 in.lb.	324	640	1 / 12
34362-1EG	24	3/8"	40~200 in.lb.	1 in.lb.	324	640	1 / 12
34362-2EG	32	3/8"	15~80 ft.lb.	0.5 ft.lb.	435	1300	1 / 12
34462-1EG	32	1/2"	20~150 ft.lb.	1 ft.lb.	521	1590	1 / 12
34462-2EG	32	1/2"	50~250 ft.lb.	1 ft.lb.	613	1810	1 / 12
34662-1EG	24	3/4"	100~450 ft.lb.	5 ft.lb.	1048	5500	1 / 2
34662-2EG	24	3/4"	100~600 ft.lb.	5 ft.lb.	1234	5600	1 / 2
34662-3EG	24	3/4"	150~750 ft.lb.	5 ft.lb.	1238	6150	1 / 2
34662-4EG	24	3/4"	60~300 ft.lb.	2 ft.lb.	614	1800	1 / 12
34862-1EG	24	1"	150~750 ft.lb.	5 ft.lb.	1238	6150	1 / 2

Dual Scale - Newton Meter & English (Nm & ft.lb.)

KT NO.	Gear teeth	Square drive	Torque range Nm	Incr.	Torque range ft. lb.	Incr.	Overall length mm		
34462-1FG	32	1 / 2"	40~200 Nm	1 Nm	33.2~143.8 ft.lb.	0.8 ft.lb.	521	1590	1 / 12
34462-2FG	32	1 / 2"	60~340 Nm	2 Nm	51.6~243.4 ft.lb.	1.5 ft.lb.	613	1720	1 / 12
34862-1FG	24	1"	200~1000 Nm	5 Nm	166~719 ft.lb.	5 ft.lb.	1238	6150	1 / 2

Dual Scale - Kilogram-force Centimeter & Newton Meter (kgf.cm & Nm)

KT NO.	Gear teeth	Square drive	Torque range kgf.cm / kgf.m	Incr.	Torque range Nm	Incr.	Overall length mm		
34262-1GG	24	1/4"	40~200 Kgf.cm	1 Kgf.cm	4.4~19.1 Nm	0.92 Nm	324	640	1 / 12
34362-1GG	24	3/8"	40~200 Kgf.cm	1 Kgf.cm	4.4~19.1 Nm	0.92 Nm	324	640	1 / 12
34362-2GG	32	3/8"	200~1000 Kgf.cm	5 Kgf.cm	22.1~95.6 Nm	0.46 Nm	435	1300	1 / 12
34462-1GG	32	1/2"	400~2000 Kgf.cm	10 Kgf.cm	44.1~191.2 Nm	0.46 Nm	521	1590	1 / 12
34462-2GG	32	1/2"	6~34 Kgf.m	0.2 Kgf.m	68.6~323.6 Nm	1.82 Nm	613	1810	1 / 12
34462-3GG	32	1/2"	200~1000 Kgf.cm	0.5 Kgf.cm	22.1~95.6 Nm	4.9 Nm	436	1470	1 / 12
34662-1GG	24	3/4"	10~60 Kgf.m	0.5 Kgf.m	123~564 Nm	4.9 Nm	1048	5500	1 / 2
34662-2GG	24	3/4"	15~80 Kgf.m	0.5 Kgf.m	172~760 Nm	4.9 Nm	1234	5600	1 / 2
34662-3GG	24	3/4"	20~100 Kgf.m	0.5 Kgf.m	221~956 Nm	4.9 Nm	1238	6150	1 / 2
34862-1GG	24	1"	20~100 Kgf.m	0.5 Kgf.m	221~956 Nm	4.9 Nm	1238	6150	1 / 2



Heavy Duty Adjustable Torque Wrench

Design for easy torque adjustment

Quality accords to DIN ISO 6789:2017 & ASME B107.300-2010

Tolerance of torque $\pm 3\%$ (CW)

CW/CCW Direction



1 Nm = 0.738 ft.lb. = 0.102 kgf.m
 1 ft.lb. = 1.356 Nm = 0.138 kgf.m
 1 in.lb. = 0.113 Nm = 1.152 kgf.cm

34862-2CF, 34862-2DF
 34862-2EF, 34862-2FF



34862-2CG, 34862-2DG
 34862-2EG, 34862-2FG
 34862-2GG

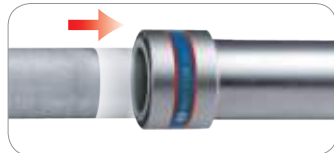

In order to ensure correct torque the extension bar must be used



Dual Scale - English & Newton Meter (ft.lb. & Nm)

KT NO.	Square drive	Torque Rrange ft. lb.	Incr.	Torque range Nm	Incr.	Overall length mm		
● 34862-2CG	1"	200~1000 ft.lb.	5 ft.lb.	305~1322 Nm	6.8 Nm	1850	12200	1 / 2
● 34862-2CF	1"	200~1000 ft.lb.	5 ft.lb.	305~1322 Nm	6.8 Nm	1850	12200	1 / 2

Single scale - Newton Meter (Nm)

KT NO.	Square drive	Torque range Nm	Incr.	Overall length mm		
● 34862-2DF	1"	300~1500 Nm	10 Nm	1850	12200	1 / 2
● 34862-2DG	1"	300~1500 Nm	10 Nm	1850	12200	1 / 2



1. Do not use this torque wrench over its scale range.
2. Do not use this torque wrench as a normal hand tool.
3. Torque wrench need to be calibrated periodically for accuracy.

Single scale - English (ft.lb.)

KT NO.	Square drive	Torque range ft. lb.	Incr.	Overall length mm		
● 34862-2EG	1"	200~1000 ft.lb.	5 ft.lb.	1850	12200	1 / 2
● 34862-2EF	1"	200~1000 ft.lb.	5 ft.lb.	1850	12200	1 / 2



- 34862-1DK-series No. before 0805xxx
- 34862-2DK-series No. after 0805xxx

Dual Scale - Newton Meter & English (Nm & ft.lb.)

KT NO.	Square drive	Torque range Nm	Incr.	Torque range ft. lb.	Incr.	Overall length mm		
● 34862-2FF	1"	300~1500 Nm	10 Nm	258~1070 ft.lb.	7.4 ft. lb.	1850	12200	1 / 2
● 34862-2FG	1"	300~1500 Nm	10 Nm	258~1070 ft.lb.	7.4 ft. lb.	1850	12200	1 / 2

Dual Scale - Kilogram-force Centimeter & Newton Meter (kgf.cm & Nm)

KT NO.	Square drive	Torque range kgf.cm / kgf.m	Incr.	Torque range Nm	Incr.	Overall length mm		
● 34862-2GG	1"	30~150 Kgf.m	1 Kgf.m	343~1422 Nm	5 Nm	1850	12200	1 / 2



Heavy Duty Adjustable Torque Wrench

Design for easy torque adjustment

Quality accords to DIN ISO 6789:2017 & ASME B107.300-2010

Tolerance of torque $\pm 3\%$ (CW)

CW/CCW Direction

1 Nm = 0.738 ft.lb. = 0.102 kgf.m
 1 ft.lb. = 1.356 Nm = 0.138 kgf.m
 1 in.lb. = 0.113 Nm = 1.152 kgf.cm



Push through mechanism for easy repair

Wide range of choice
Distinct laser scale

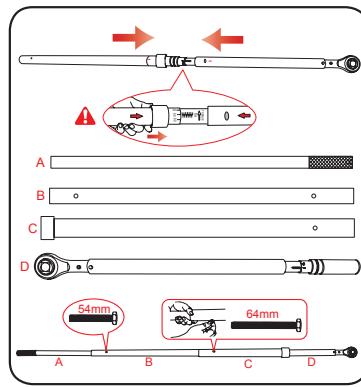
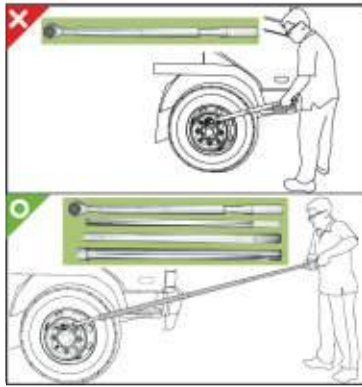

1. Do not use this torque wrench over its scale range.
2. Do not use this torque wrench as a normal hand tool.
3. Torque wrench need to be calibrated periodically for accuracy.

Dual Scale - English & Newton Meter (in.lb. / ft.lb. & Nm)

KT NO.	Square drive	Torque range ft.lb.	Incr.	Torque range Nm	Incr.	Overall length mm		
34862-3CF	1"	400~2000 ft.lb.	10 ft.lb.	610~2644 Nm	13.55 Nm	2755	23990	1 / 1
KT NO.	Square drive	Torque range Nm	Incr.	Torque range ft.lb.	Incr.	Overall length mm		
34862-3FF	1"	500~2500 Nm	14.77 ft.lb.	443~1771 ft.lb.	20 Nm	2755	25380	1 / 1

Heavy Duty Mini-type Torque Wrench

Industrial application

Quality accords to DIN ISO 6789:2017 &

ASME B107.300-2010 Tolerance of torque

$\pm 3\%$ (CW)

CW/CCW Direction



Quick release



Automatic quickly return adjustment

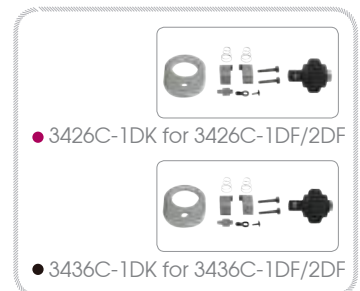

Single scale - Newton Meter (Nm)

KT NO.	Square drive	Torque range Nm	Incr.	Overall length mm		
● 3426C-1DF	1/4"	3~15 Nm	0.1 Nm	211	330	24
● 3426C-2DF	1/4"	5~25 Nm	0.2 Nm	249	430	24
● 3436C-1DF	3/8"	3~15 Nm	0.1 Nm	211	450	24
● 3436C-2DF	3/8"	5~25 Nm	0.2 Nm	249	550	24

Heavy Duty 72 Teeth Adjustable Torque Wrench

Colorful quick release button design

Fixed head version allows using in narrow spaces

Quality accords to DIN ISO 6789:2017 & ASME B107.300-2010

Tolerance of torque $\pm 3\%$ (CW)

CW/CCW Direction

1 Nm = 0.738 ft.lb. = 0.102 kgf.m
 1 ft.lb. = 1.356 Nm = 0.138 kgf.m
 1 in.lb. = 0.113 Nm = 1.152 kgf.cm



Single scale - Newton Meter (Nm)

KT NO.	Square drive	Torque range Nm	Incr.	Overall length mm			
● 3426A-1DG	1/4"	2~10 Nm	0.1 Nm	285	560	1 / 24	
● 3426A-2DG	1/4"	4~20 Nm	0.1 Nm	325	640	1 / 24	
● 3436A-2DG	3/8"	20~100 Nm	0.5 Nm	430	1300	1 / 12	
● 3446A-1DG	1/2"	40~200 Nm	1 Nm	490	1460	1 / 12	
● 3446A-2DG	1/2"	60~340 Nm	2 Nm	590	1750	1 / 12	

Single scale - English (in.lb./ft.lb.)

KT NO.	Square drive	Torque range in. lb. / ft. lb.	Incr.	Overall length mm			
● 3426A-1EG	1/4"	20~100 in.lb.	1 in.lb.	285	560	1 / 24	
● 3426A-2EG	1/4"	40~200 in.lb.	1 in.lb.	325	640	1 / 24	
● 3436A-2EG	3/8"	15~80 ft.lb.	0.5 ft.lb.	430	1300	1 / 12	
● 3446A-1EG	1/2"	20~150 ft.lb.	1 ft.lb.	490	1460	1 / 12	
● 3446A-2EG	1/2"	50~250 ft.lb.	1 ft.lb.	590	1750	1 / 12	

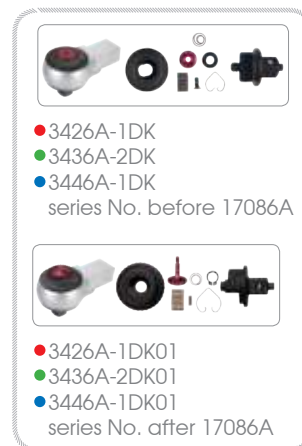

1. Do not use this torque wrench over its scale range.
2. Do not use this torque wrench as a normal hand tool.
3. Torque wrench need to be calibrated periodically for accuracy.

Heavy Duty Interchangeable Torque Wrench

Using standard insert head

Positive button design which removes the insert head easily

Quality accords to DIN ISO 6789:2017 & ASME B107.300-2010

Tolerance of torque $\pm 3\%$ (CW)

CW/CCW Direction

1 Nm = 0.738 ft.lb. = 0.102 kgf.m

1 ft.lb. = 1.356 Nm = 0.138 kgf.m

1 in.lb. = 0.113 Nm = 1.152 kgf.cm



Dual Scale - English & Newton Meter (ft.lb. & Nm)

KT NO.	Size mm	Torque range ft. lb.	Incr.	Torque range Nm	Incr.	Overall length mm		
34512-1CG	9 x 12	20~100 in.lb.	1 in.lb	2.8~10.7 Nm	0.12 Nm	261	510	1 / 12
34512-2CG	9 x 12	40~200 in.lb.	1 in.lb	5.1~22.0 Nm	0.12 Nm	306	590	1 / 12
34512-3CG	9 x 12	15~80 ft.lb.	0.5 ft.lb	23.7~105.1 Nm	0.7 Nm	430	1270	1 / 12
34522-1CG	14 x 18	15~80 ft.lb.	0.5 ft.lb	23.7~105.1 Nm	0.7 Nm	430	1270	1 / 12
34522-2CG	14 x 18	20~150 ft.lb.	1 ft.lb	34~197 Nm	1.4 Nm	485	1410	1 / 12
34522-3CG	14 x 18	50~250 ft.lb.	1 ft.lb	75~332 Nm	1.4 Nm	580	1590	1 / 12

Single scale - Newton Meter (Nm)

KT NO.	Size mm	Torque range Nm	Incr.	Overall length mm		
34512-1DG	9 x 12	2~10 Nm	0.1 Nm	261	510	1 / 12
34512-2DG	9 x 12	4~20 Nm	0.1 Nm	306	590	1 / 12
34512-4DG	9 x 12	10~60 Nm	0.5 Nm	306	590	1 / 12
34512-3DG	9 x 12	20~100 Nm	0.5 Nm	430	1270	1 / 12
34522-1DG	14 x 18	20~100 Nm	0.5 Nm	430	1270	1 / 12
34522-2DG	14 x 18	40~200 Nm	1 Nm	485	1410	1 / 12
34522-3DG	14 x 18	60~340 Nm	2 Nm	580	1590	1 / 12
34522-4DG	14 x 18	100~600 Nm	5 Nm	1015	6200	1 / 2
34522-5DG	14 x 18	10~60 Nm	0.5 Nm	360	1270	1 / 12
34522-6DG	14 x 18	150~800 Nm	5 Nm	1195	6620	1 / 2
34522-7DG	14 x 18	70~350 Nm	2 Nm	580	1800	1 / 12
34522-8DG	14 x 18	200~1000 Nm	5 Nm	1200	6620	1 / 2
34522-9DG	14 x 18	80~400 Nm	2 Nm	580	1780	1 / 12

Single scale - English (in.lb./ft.lb.)

KT NO.	Size mm	Torque range in. lb. / ft. lb.	Incr.	Overall length mm		
34512-1EG	9 x 12	20~100 in.lb.	1 in.lb	261	510	1 / 12
34512-2EG	9 x 12	40~200 in.lb.	1 in.lb	306	590	1 / 12
34512-3EG	9 x 12	15~80 ft.lb.	0.5 ft.lb	430	1270	1 / 12
34522-1EG	14 x 18	15~80 ft.lb.	0.5 ft.lb	430	1270	1 / 12
34522-2EG	14 x 18	20~150 ft.lb.	1 ft.lb	485	1410	1 / 12
34522-3EG	14 x 18	50~250 ft.lb.	1 ft.lb	580	1590	1 / 12

Dual Scale - Newton Meter & English (Nm & ft.lb.)

KT NO.	Size mm	Torque range Nm	Incr.	Torque range ft. lb.	Incr.	Overall length mm		
34512-1FG	9 x 12	2~10 Nm	0.1 Nm	22.1~84.1 in.lb.	0.9 in.lb	261	510	1 / 12
34512-2FG	9 x 12	4~20 Nm	0.1 Nm	39.8~172.6 in.lb.	0.9 in.lb	306	590	1 / 12
34512-3FG	9 x 12	20~100 Nm	0.5 Nm	16.6~71.9 ft.lb.	0.4 ft.lb	430	1270	1 / 12
34522-1FG	14 x 18	20~100 Nm	0.5 Nm	16.6~71.9 ft.lb.	0.4 ft.lb	430	1270	1 / 12
34522-2FG	14 x 18	40~200 Nm	1 Nm	33.2~143.8 ft.lb.	0.8 ft.lb	485	1410	1 / 12
34522-3FG	14 x 18	60~340 Nm	2 Nm	51.6~243.4 ft.lb.	1.5 ft.lb	580	1590	1 / 12



1. Do not use this torque wrench over its scale range.
2. Do not use this torque wrench as a normal hand tool.
3. Torque wrench need to be calibrated periodically for accuracy.



Insert Tool

1 Nm = 0.738 ft.lb. = 0.102 kgf.m
 1 ft.lb. = 1.356 Nm = 0.138 kgf.m
 1 in.lb. = 0.113 Nm = 1.152 kgf.cm

345031

• Chrome plated

- Ratchet insert tool
- 5° gear action degree (72 teeth)

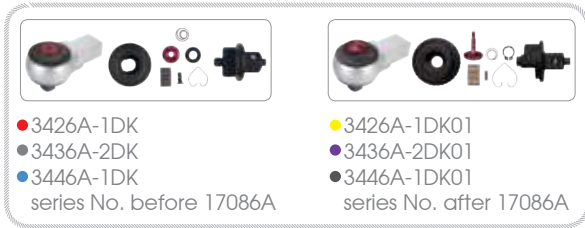

KT NO.	Size	mm	Lw* mm	L mm	g	kg
● 34503102R	1/4"DR	9 x 12	17	46	71	12 / 192
● 34503103R	3/8"DR	9 x 12	17.6	48.8	106	10 / 160
● 34503104R	1/2"DR	9 x 12	25	60	234	6 / 96

345032

• Chrome plated

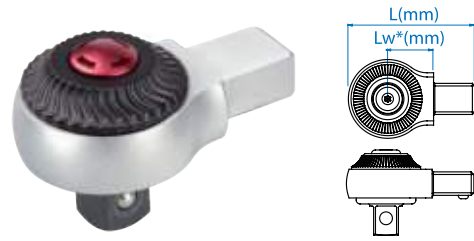

KT NO.	Size	mm	Lw* mm	L mm	g	kg
● 34503203R	3/8"DR	14 x 18	27	70	218	6 / 96
● 34503204R	1/2"DR	14 x 18	27	70	256	6 / 96
● 34503206R	3/4"DR	14 x 18	27	71.5	348	4 / 64

345011

• Chrome plated

- Open end insert Tool

KT NO.	Size mm	mm	Lw* mm	L mm	g	kg
34501107M	7	9 x 12	17.5	37.4	36	12 / 192
34501108M	8	9 x 12	17.5	37.9	37	12 / 192
34501109M	9	9 x 12	17.5	37.9	37	12 / 192
34501110M	10	9 x 12	17.5	38.2	41	12 / 192
34501111M	11	9 x 12	17.5	39.0	39	12 / 192
34501112M	12	9 x 12	17.5	39.0	40	12 / 192
34501113M	13	9 x 12	17.5	39.3	45	12 / 192
34501114M	14	9 x 12	20	43.1	54	12 / 192
34501115M	15	9 x 12	20	43.4	55	12 / 192
34501116M	16	9 x 12	20	43.9	57	12 / 192
34501117M	17	9 x 12	20	44.4	58	12 / 192
34501118M	18	9 x 12	20	45.3	59	12 / 192
34501119M	19	9 x 12	20	45.0	64	12 / 192
34501121M	21	9 x 12	25	52.4	120	10 / 160
34501122M	22	9 x 12	25	53.1	124	10 / 160
34501124M	24	9 x 12	25	54.1	128	8 / 128
34501127M	27	9 x 12	32.5	60.1	189	8 / 128
34501130M	30	9 x 12	32.5	60.9	195	10 / 80
34501132M	32	9 x 12	32.5	62.6	213	10 / 80
34501136M	36	9 x 12	32.5	64.8	213	10 / 80

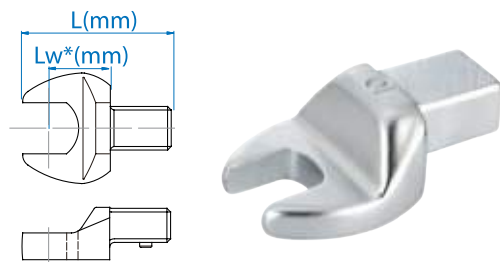



KT NO.	Size inch	mm	Lw* mm	L mm	g	kg
34501108S	1/4	9 x 12	17	37	36	12 / 192
34501110S	5/16	9 x 12	17	37	38	12 / 192
34501112S	3/8	9 x 12	17	38	39	12 / 192
34501114S	7/16	9 x 12	17	39	41	12 / 192
34501116S	1/2	9 x 12	17	39	43	12 / 192
34501118S	9/16	9 x 12	20	43	53	12 / 192
34501120S	5/8	9 x 12	20	43	57	12 / 192
34501122S	11/16	9 x 12	20	44	62	12 / 192
34501124S	3/4	9 x 12	20	45	65	12 / 192

Insert Tool

1 Nm = 0.738 ft.lb. = 0.102 kgf.m
 1 ft.lb. = 1.356 Nm = 0.138 kgf.m
 1 in.lb. = 0.113 Nm = 1.152 kgf.cm

345014

• Chrome plated

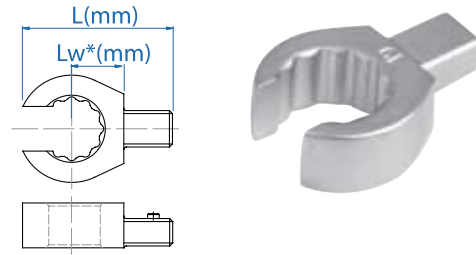

KT NO.	Size mm	mm	Lw* mm	L mm		
34501410M	10	9 x 12	17.5	42.4	51.6	12 / 192
34501411M	11	9 x 12	17.5	43.0	53.0	12 / 192
34501412M	12	9 x 12	17.5	43.8	55.0	12 / 192
34501413M	13	9 x 12	17.5	43.9	53.8	12 / 192
34501414M	14	9 x 12	17.5	44.3	57.6	12 / 192
34501416M	16	9 x 12	17.5	45.0	58.6	12 / 192
34501417M	17	9 x 12	17.5	45.4	65.0	12 / 192
34501418M	18	9 x 12	17.5	46.0	66.2	12 / 192
34501419M	19	9 x 12	17.5	46.7	73.0	12 / 192
34501421M	21	9 x 12	17.5	47.6	72.2	12 / 192
34501422M	22	9 x 12	17.5	48.5	74.2	12 / 192





345021

• Chrome plated

▪ Ring insert tool

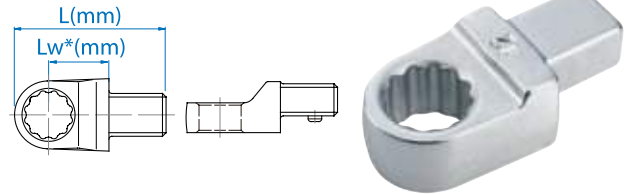

KT NO.	Size mm	mm	Lw* mm	L mm		
34502107M	7	9 x 12	17.5	39	37	12 / 288
34502108M	8	9 x 12	17.5	40	36	12 / 288
34502110M	10	9 x 12	17.5	41	39	12 / 288
34502111M	11	9 x 12	17.5	43	42	12 / 288
34502112M	12	9 x 12	17.5	43	51	12 / 288
34502113M	13	9 x 12	17.5	44	51	12 / 288
34502114M	14	9 x 12	17.5	45	52	12 / 288
34502115M	15	9 x 12	17.5	45	53	12 / 288
34502116M	16	9 x 12	17.5	46	56	12 / 288
34502117M	17	9 x 12	17.5	47	55	12 / 192
34502118M	18	9 x 12	17.5	47	60	12 / 192
34502119M	19	9 x 12	17.5	49	63	12 / 192
34502121M	21	9 x 12	17.5	50	68	12 / 192
34502122M	22	9 x 12	17.5	51	70	12 / 192





KT NO.	Size inch	mm	Lw* mm	L mm		
34502108S	1/4	9 x 12	17.5	39	38	12 / 288
34502110S	5/16	9 x 12	17.5	40	37	12 / 288
34502112S	3/8	9 x 12	17.5	41	42	12 / 288
34502114S	7/16	9 x 12	17.5	43	41	12 / 288
34502116S	1/2	9 x 12	17.5	43	52	12 / 288
34502118S	9/16	9 x 12	17.5	45	53	12 / 288
34502120S	5/8	9 x 12	17.5	46	58	12 / 288
34502122S	11/16	9 x 12	17.5	47	62	12 / 192
34502124S	3/4	9 x 12	17.5	49	62	12 / 192
34502126S	13/16	9 x 12	17.5	50	72	12 / 192
34502128S	7/8	9 x 12	17.5	51	69	12 / 192

345012

• Chrome plated

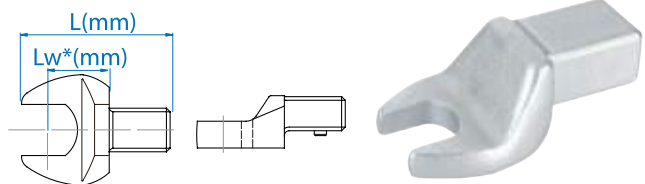
KT NO.	Size mm	mm	Lw* mm	L mm		
34501213M	13	14 x 18	25	58	117	12 / 192
34501214M	14	14 x 18	25	58	120	12 / 192
34501215M	15	14 x 18	25	58	116	12 / 192
34501216M	16	14 x 18	25	59	127	10 / 160
34501217M	17	14 x 18	25	60	138	10 / 160
34501218M	18	14 x 18	25	60	136	10 / 160
34501219M	19	14 x 18	25	61	140	10 / 160
34501221M	21	14 x 18	25	61	160	6 / 96
34501222M	22	14 x 18	25	62	162	6 / 96
34501223M	23	14 x 18	25	62	163	6 / 96
34501224M	24	14 x 18	25	63	168	6 / 96
34501225M	25	14 x 18	25	69	180	6 / 96
34501226M	26	14 x 18	30	69	210	6 / 96
34501227M	27	14 x 18	32.5	69	239	6 / 96
34501230M	30	14 x 18	32.5	70	249	6 / 96
34501232M	32	14 x 18	32.5	73	248	6 / 72
34501234M	34	14 x 18	32.5	74	252	6 / 72
34501236M	36	14 x 18	32.5	75	244	6 / 72
34501238M	38	14 x 18	32.5	74	229	6 / 72
34501240M	40	14 x 18	37	80	280	6 / 72
34501241M	41	14 x 18	40	80	315	6 / 72



KT NO.	Size inch	mm	Lw* mm	L mm		
34501216S	1/2	14 x 18	25	58	117	12 / 192
34501218S	9/16	14 x 18	25	58	120	12 / 192
34501220S	5/8	14 x 18	25	59	127	10 / 160
34501222S	11/16	14 x 18	25	60	138	10 / 160
34501224S	3/4	14 x 18	25	61	140	10 / 160
34501226S	13/16	14 x 18	25	61	160	6 / 96
34501228S	7/8	14 x 18	25	62	162	6 / 96
34501230S	15/16	14 x 18	25	63	168	6 / 96
34501232S	1	14 x 18	25	69	180	6 / 96
34501236S	1-1/8	14 x 18	32.5	70	249	6 / 96
34501240S	1-1/4	14 x 18	32.5	73	248	6 / 96
34501248S	1-1/2	14 x 18	32.5	74	229	6 / 96



Insert Tool

345022

• Chrome plated

KT NO.	Size mm	mm	Lw* mm	L mm		
34502213M	13	14 x 18	25	62	129	12 / 192
34502214M	14	14 x 18	25	63	132	12 / 192
34502215M	15	14 x 18	25	63	132	12 / 192
34502216M	16	14 x 18	25	63	137	12 / 192
34502217M	17	14 x 18	25	65	141	12 / 192
34502218M	18	14 x 18	25	65	138	10 / 160
34502219M	19	14 x 18	25	66	144	10 / 160
34502221M	21	14 x 18	25	67	151	10 / 160
34502222M	22	14 x 18	25	68	156	6 / 96
34502224M	24	14 x 18	25	69	161	6 / 96
34502227M	27	14 x 18	32.5	78	204	6 / 96
34502230M	30	14 x 18	32.5	79	204	6 / 96
34502232M	32	14 x 18	32.5	81	213	6 / 96
34502234M	34	14 x 18	32.5	82	225	6 / 90
34502236M	36	14 x 18	32.5	83	230	6 / 90
34502241M	41	14 x 18	40	86	235	6 / 90

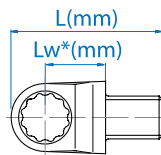

KT NO.	Size inch	mm	Lw* mm	L mm		
34502216S	1/2	14 x 18	25	62	129	12 / 192
34502218S	9/16	14 x 18	25	63	132	12 / 192
34502220S	5/8	14 x 18	25	63	137	12 / 192
34502224S	3/4	14 x 18	25	66	144	10 / 160

Interchangeable Torque Wrench Set

34510

34520

1 Nm = 0.738 ft.lb. = 0.102 kgf.m
 1 ft.lb. = 1.356 Nm = 0.138 kgf.m
 1 in.lb. = 0.113 Nm = 1.152 kgf.cm



KT NO.	mm	Contents						
345102D08MR	9 x 12	34512-2DG 4~20 Nm	34503102R	1/4" DR	345011M	345021M	1.3	1 / 15
345104D08MR		34512-4DG 10~60 Nm	34503103R	3/8" DR			1.3	1 / 15
345101E08MR		34512-1EG 20~100 in.lb.	34503102R	1/4" DR			1.2	1 / 15
345102E08MR		34512-2EG 40~200 in.lb.	34503102R	1/4" DR	10, 13, 17	10, 13, 17	1.3	1 / 15

KT NO.	mm	Contents					
345201D11MR	14 x 18	34522-1DG 20~100 Nm	34503203R	3/8" DR	345012M	3.7	1 / 6
345202D11MR		34522-2DG 40~200 Nm	34503204R	1/2" DR		3.8	1 / 6
345203D11MR		34522-3DG 60~340 Nm	34503204R	1/2" DR		4	1 / 6
345201E11MR		34522-1EG 15~80 ft.lb.	34503203R	3/8" DR		3.7	1 / 6
345202E11MR		34522-2EG 20~150 ft.lb.	34503204R	1/2" DR		3.8	1 / 6
345203E11MR		34522-3EG 50~250 ft.lb.	34503204R	1/2" DR		4	1 / 6

Classic Type Adjustable Torque Wrench

Design for easy torque adjustment

Quality accords to DIN ISO 6789:2017 & ASME B107.300-2010

Tolerance of torque $\pm 4\%$ (CW)

CW/CCW Direction

1 Nm = 0.738 ft.lb. = 0.102 kgf.m
 1 ft.lb. = 1.356 Nm = 0.138 kgf.m
 1 in.lb. = 0.113 Nm = 1.152 kgf.cm

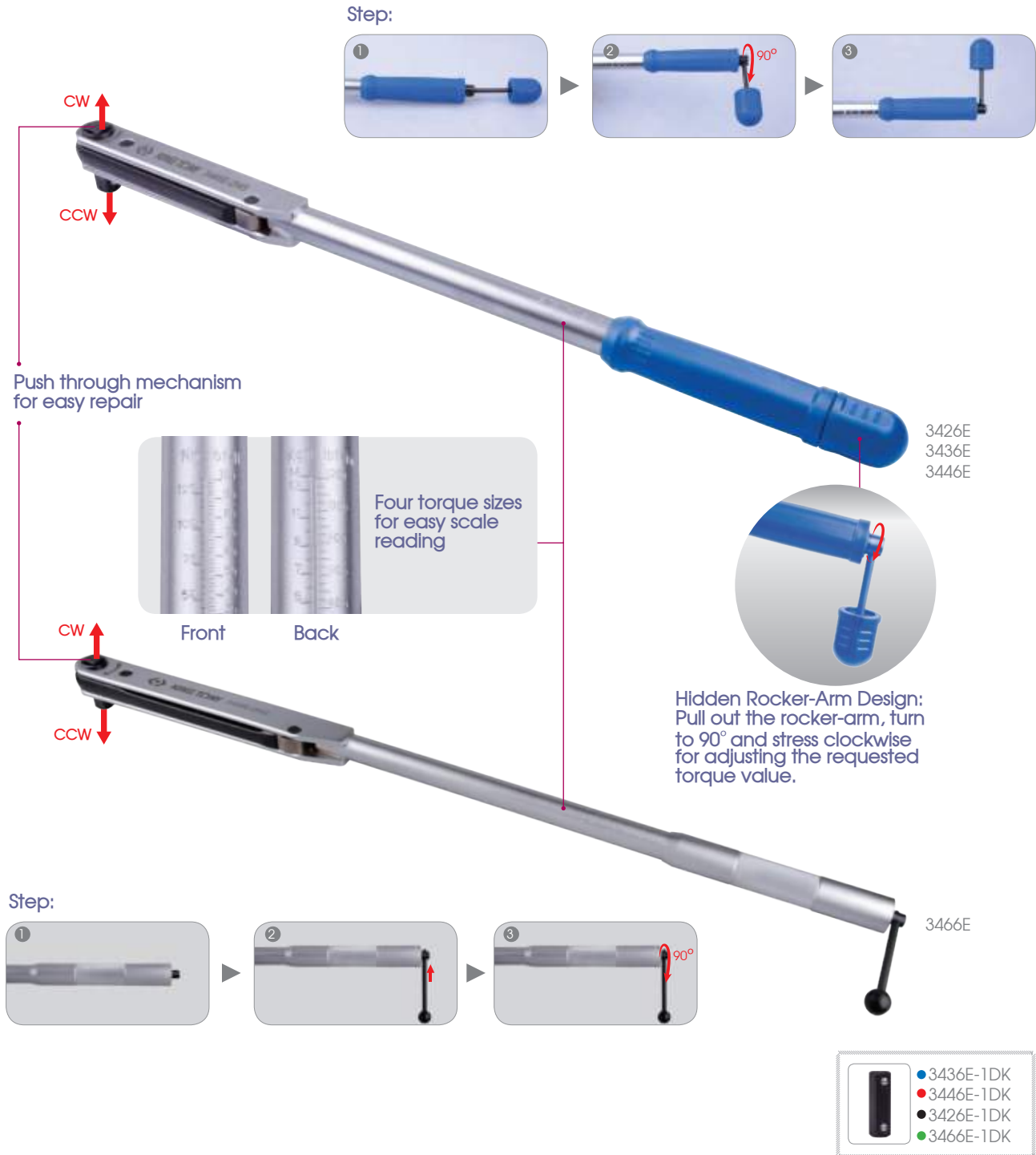

Dual Scale - English & Newton Meter (in.lb. / ft.lb. & Nm / kg.m)

KT NO.	Square drive	Torque range						Overall length		Scales	Box	
		Nm	Incr.	ft. lb.	Incr.	in. lb.	Incr.	mm	mm			
● 3426E-1HG	1/4"	2.5~11 Nm	0.5	2~8 ft.lb.	1	20~100 in.lb.	10	300~1200gm	100	352	630	1 / 12
● 3436E-1HG	3/8"	2.5~11 Nm	0.5	2~8 ft.lb.	1	20~100 in.lb.	10	300~1200gm	100	352	740	1 / 12
● 3436E-2HG	3/8"	7~33 Nm	1	5~24 ft.lb.	1	60~300 in.lb.	10	0.7~3.4 kgf.m	0.1	450	870	1 / 12
● 3436E-3HG	3/8"	14~68 Nm	2	10~50 ft.lb.	5	125~600 in.lb.	25	1.4~7 kgf.m	0.2	505	1210	1 / 12
● 3446E-1HG	1/2"	25~135 Nm	5	20~100 ft.lb.	2	200~1200 in.lb.	50	3~14 kgf.m	1	555	1640	1 / 12
● 3446E-2HG	1/2"	50~225 Nm	5	40~160 ft.lb.	5	400~2000 in.lb.	50	5~23 kgf.m	1	590	1710	1 / 12
● 3446E-3HG	1/2"	70~330 Nm	10	50~250 ft.lb.	5	600~3000 in.lb.	100	7~35 kgf.m	1	803	3440	1 / 6
● 3466E-1HG	3/4"	140~560 Nm	10	100~410 ft.lb.	10	1200~5000 in.lb.	100	14~57 kgf.m	1	977	8480	1 / 2
● 3466E-2HG	3/4"	200~800 Nm	20	150~600 ft.lb.	20	1800~7200 in.lb.	200	22~82 kgf.m	2	1033	8860	1 / 2



Click Type Adjustable Torque Wrench

Industrial application with durability

Loud click sound and strong impulse when required torque is reached

Tolerance of torque $\pm 3\%$

Quality accords to DIN ISO 6789:2017 & ASME B107.300-2010

Ideal for using on oil, chemical and noisy assembling working field

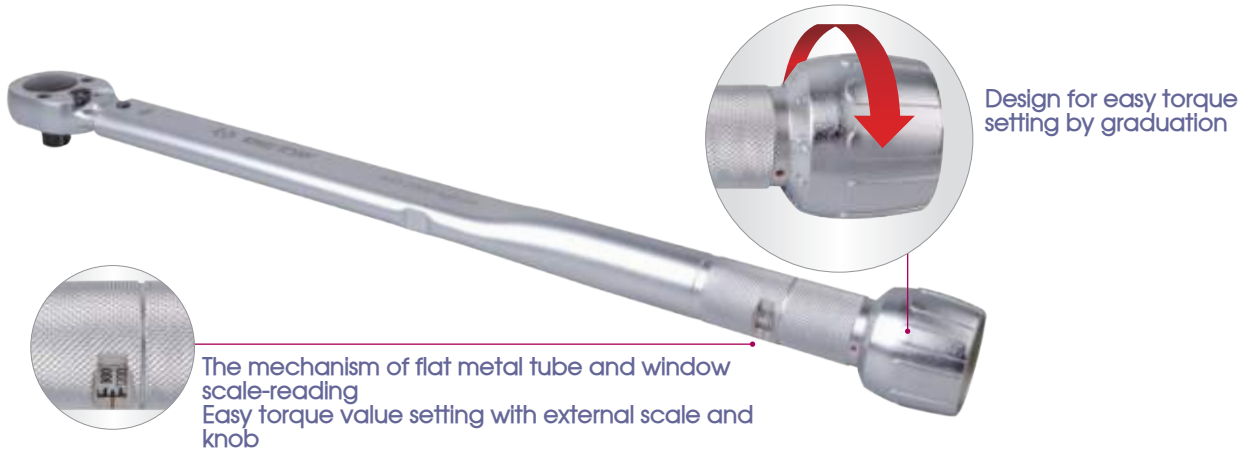

KT NO.	Gear teeth	Square drive	Torque range kgf.cm	Incr.	Overall length mm		
3432F-1KF	24	3/8"	50-250 kgf.cm	2.5 kgf.cm	240	450	1 / 24
3432F-3KF	24	3/8"	200-1000 kgf.cm	10 kgf.cm	342	800	1 / 12
3442F-1KF	24	1/2"	200-1000 kgf.cm	10 kgf.cm	342	800	1 / 12
3442F-3KF	24	1/2"	400-2000 kgf.cm	20 kgf.cm	498	1500	1 / 12

Adjustable Torque Wrench

Design for easy torque adjustment

Quality accords to DIN ISO 6789:2017 & ASME B107.300-2010

Tolerance of torque $\pm 4\%$ (CW)

CW/CCW Direction

1 Nm = 0.738 ft.lb. = 0.102 kgf.m

1 ft.lb. = 1.356 Nm = 0.138 kgf.m

1 in.lb. = 0.113 Nm = 1.152 kgf.cm

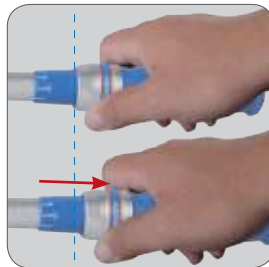

- The production of injection molding helps it against come off
- One hand operation
- Quick torque set
- Automatic torque locking



Dual Scale - Newton Meter & English (Nm / ft.lb.)

KT NO.	Gear teeth	Square drive	Torque range Nm / ft.lb.	Incr.	Overall length mm		
34464-1FG	24	1/2"	40-210 Nm (33.2-151.2 ft.lb.)	1.0 Nm	470	1250	1 / 12
34464-2FG	24	1/2"	70-340 Nm (62.7-239.7 ft.lb.)	3.0 Nm	590	1590	1 / 12

Adjustable Torque Wrench

Quality accords to DIN ISO 6789:2017 & ASME B107.300-2010

Tolerance of torque $\pm 4\%$ (CW)

CW/CCW Direction

1 Nm = 0.738 ft.lb. = 0.102 kgf.m
 1 ft.lb. = 1.356 Nm = 0.138 kgf.m
 1 in.lb. = 0.113 Nm = 1.152 kgf.cm

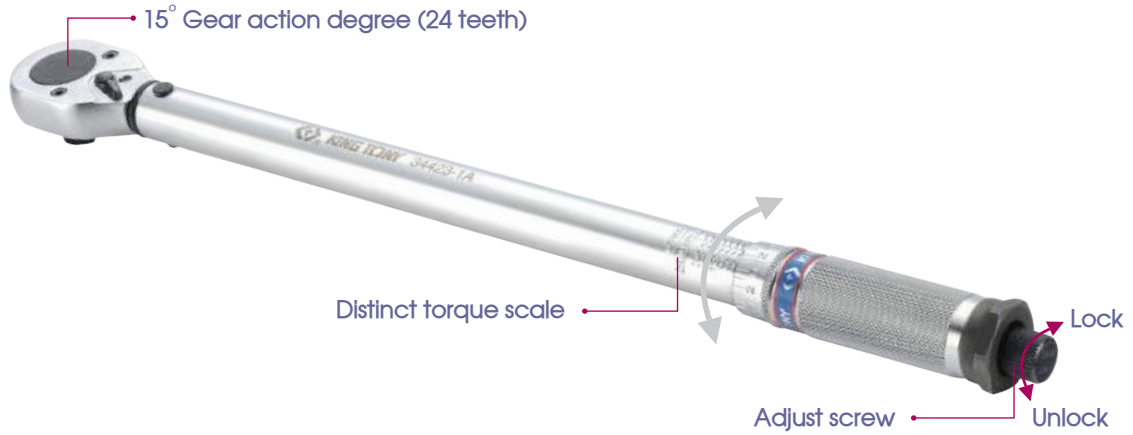

Dual Scale - Newton Meter & Kilogram-force Centimeter / Kilogram-force meter (Nm & kgf.cm / kgf.m)

KT NO.	Square drive	Torque range Nm	Incr.	Torque range kgf.cm / kgf.m	Incr.	Overall length mm		
● 34223-1A	1/4"	5~25 Nm	0.1 Nm	51~255 kgf.cm	1 kgf.cm	280	595	1 / 12
● 34323-1A	3/8"	5~25 Nm	0.1 Nm	51~255 kgf.cm	1 kgf.cm	280	595	1 / 12
● 34323-2A	3/8"	20~110 Nm	1 Nm	2.04~11.22 kgf.m	0.1 kgf.m	370	820	1 / 12
● 34423-1A	1/2"	42~210 Nm	1 Nm	4.3~21.4 kgf.m	0.41 kgf.m	450	1340	1 / 12
● 34423-2A	1/2"	70~340 Nm	3 Nm	7.1~34.7 kgf.m	0.27 kgf.m	570	2400	1 / 12

Dual Scale - English & Kilogram-force Centimeter / Kilogram-force meter (in.lb. / ft.lb. & kgf.cm / kgf.m)

KT NO.	Square drive	Torque range in. lb. / ft. lb.	Incr.	Torque range kgf.cm / kgf.m	Incr.	Overall length mm		
● 34223-1B	1/4"	55~250 in. lb.	1.5 in.lb.	63~288 kgf.cm	1.13 kgf.cm	280	595	1 / 12
● 34323-1B	3/8"	55~250 in. lb.	1.5 in.lb.	63~288 kgf.cm	1.13 kgf.cm	280	595	1 / 12
● 34323-2B	3/8"	15~80 ft. lb.	0.5 ft.lb.	2.1~11.10 kgf.m	0.07 kgf.m	370	820	1 / 12
● 34423-1B	1/2"	30~150 ft. lb.	1 ft.lb.	4.2~20.8 kgf.m	0.14 kgf.m	450	1340	1 / 12
● 34423-2B	1/2"	50~250 ft. lb.	2 ft.lb.	6.9~34.6 kgf.m	0.27 kgf.m	570	2400	1 / 12

Dual Scale - English & Kilogram-force Centimeter / Kilogram-force meter (in.lb. / ft.lb. & kgf.cm / kgf.m)

KT NO.	Square drive	Torque range in. lb. / ft. lb.	Incr.	Torque range kgf.cm / kgf.m	Incr.	Overall length mm		
● 34223-1C	1/4"	55~250 in.lb.	1 in.lb.	6.2~28.2 Nm	0.17 Nm	280	595	1 / 12
● 34323-1C	3/8"	55~250 in.lb.	1 in.lb.	6.2~28.2 Nm	0.17 Nm	280	595	1 / 12
● 34323-2C	3/8"	15~80 ft.lb.	0.5 ft.lb.	20.3~108.5 Nm	0.68 Nm	370	820	1 / 12
● 34423-1C	1/2"	30~150 ft.lb.	1 ft.lb.	40.7~203.4 Nm	1.35 Nm	450	1658	1 / 12
● 34423-2C	1/2"	50~250 ft.lb.	2 ft.lb.	67.8~339 Nm	2.71 Nm	570	2400	1 / 12



● 34223-1DK1



● 34323-1DK1
● 34323-2DK1



● 34423-1DK1(24T)
-series NO. before 090923xxxx



● 34423-3DK(24T)
-series NO. after 1309230001



1. Do not use this torque wrench over its scale range.
2. Do not use this torque wrench as a normal hand tool.
3. Torque wrench need to be calibrated periodically for accuracy.



Heavy Duty Aluminum Adjustable Torque Wrench

Industrial application

Lightweight and robust; housing made by aluminium alloy

Multi-lever mechanism brings length independence and accurate torque

Loud click sound and string impulse when torque value reached

Easy lock and adjustment design

Tolerance of torque $\pm 3\%$

Quality accords to DIN ISO 6789:2017 & ASME B107.300-2010

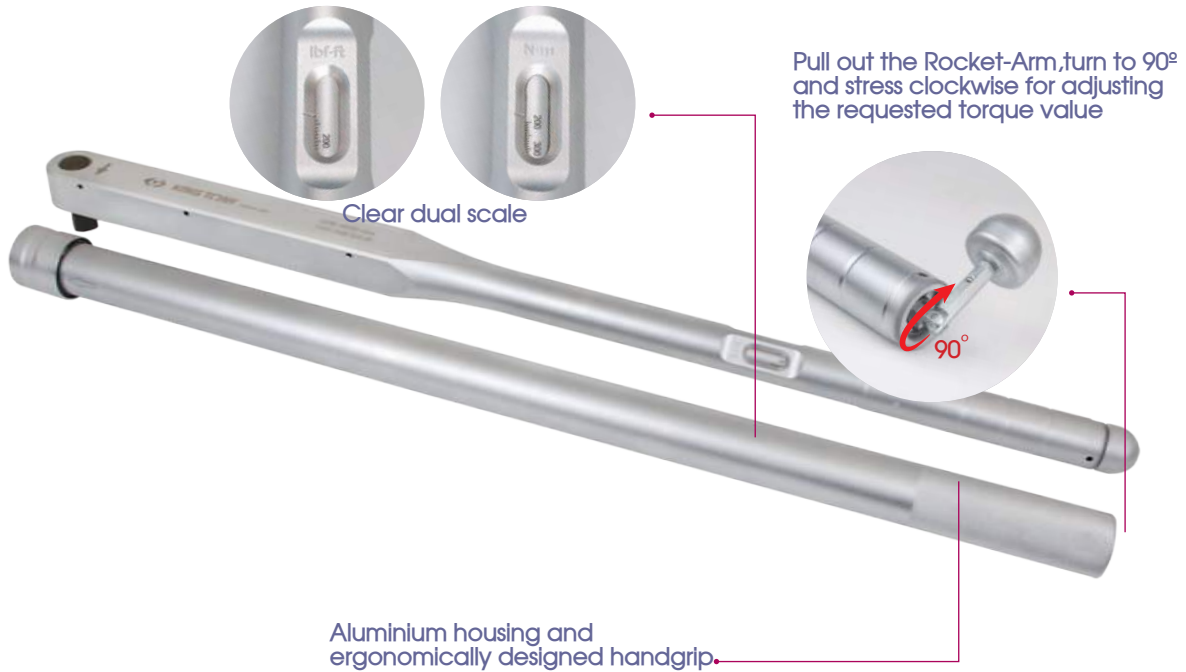

Step:

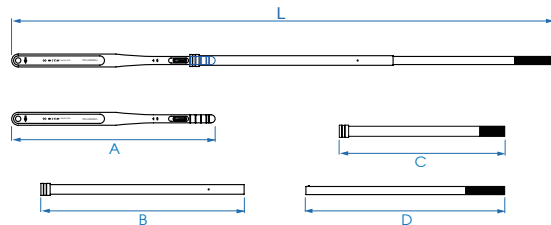

Dual Scale - English & Newton Meter (ft. lb. & Nm)

KT NO.	Square drive	Torque range				A	B	C	D	Overall length mm	kg	/
		Nm	Incr.	ft.lb.	Incr.							
3445G-1FB	1/2"	40~200 Nm	5	30~150 ft.lb.	5	563	-	-	-	563	1.50	1 / 12
3465G-1FB	3/4"	110~550 Nm	10	80~400 ft.lb.	10	827	-	-	-	827	3.00	1 / 2
3465G-2FB	3/4"	140~760 Nm	10	100~560 ft.lb.	10	827	-	-	-	827	3.00	1 / 2
3465G-3FB	3/4"	200~1000 Nm	10	140~740 ft.lb.	10	825	-	762	-	1413	3.80	1 / 2
3485G-1DB	1"	600~1500 Nm	25	-	-	947	771	-	362	1615	10.90	1 / 1
3485G-2DB	1"	750~2000 Nm	50	-	-	947	946	-	925	2370	11.70	1 / 1

Electronic Torque Wrench



- Electronic torque value readout
- Peak hold and track mode selection
- Angle accuracy (34387/34487)
- Buzzer and LED indicator for presetting target torque
- Engineering units (Nm, ft.lb, in.lb, kgf.m) adjustment
- Switch off automatically after 60 seconds
- DIN ISO 6789:2017 & ASME B107.300-2010
- CW $\pm 2\%$ and CCW $\pm 3\%$ operation



1 Nm = 0.738 ft.lb. = 0.102 kgf.m
 1 ft.lb. = 1.356 Nm = 0.138 kgf.m
 1 in.lb. = 0.113 Nm = 1.152 kgf.m



• Electronic Torque Wrench (34367-2AG, 34467-1AG)

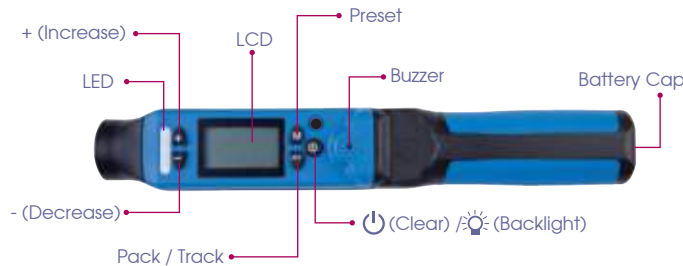

Torque Accuracy	CW $\pm 2\%$ / CCW $\pm 3\%$
Preset function	10
Display Resolution	0.1 Nm/ ft.lb. .001 kgf.m, 1.0 lb.in
Operation Mode	Peak/Trace
Unit Selection	kg.m, lb.in, lb.ft, Nm
Gear Teeth	36/72
Battery	AAA x 3 PC.
Battery Life	110 hrs (continuous operation)
Operating Ambient Temperature	-10°C - 60°C (13.9°F - 139.9°F)
Storage Temperature	-20°C - 70°C (-4°F - 157.9°F)
Operating Relative Humidity	15 to 90% noncondensing
Switch off Automatically	60 seconds (if do not use torque wrench)
Angle Accuracy	($\pm 1\%$ of reading) + ($\pm 1\%$ @ angular velocity $> 10^\circ/\text{sec} < 180^\circ/\text{sec}$) + ($\pm 1\%$ of Text Texture)
Angle	0° ~ 360° (34387-2AG, 34487-1AG)

• Electronic Torque Angle-controlled Wrench (34387-2AG, 34487-1AG)

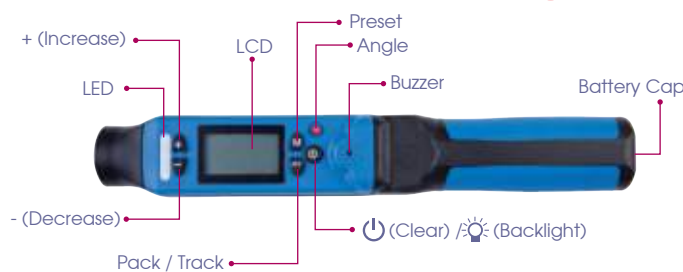

Dual Scale - English & Newton Meter (in.lb. / ft.lb. & Nm / kg.m)

KT NO.	Square drive	Torque range				Overall length mm	Scales	Box
		Nm	ft.lb.	in. lb.	kg.m			
34367-2AG	3/8"	27-135 Nm	19.9-99.6 ft.lb.	239-1195 in.lb.	2.75-13.76 kgf.m	460	1400	1 / 6
34467-1AG	1/2"	40-200 Nm	29.5-147.5 ft.lb.	354-1770 in.lb.	4.08-20.38 kgf.m	530	1500	1 / 6
34387-2AG	3/8"	27-135 Nm	19.9-99.6 ft.lb.	239-1195 in.lb.	2.75-13.76 kgf.m	460	1400	1 / 6
34487-1AG	1/2"	40-200 Nm	29.5-147.5 ft.lb.	354-1770 in.lb.	4.08-20.38 kgf.m	530	1500	1 / 6



- Do not press "M" and "⏻" button together otherwise system will enter in calibration mode.
- Switch off the power after use.



Electronic Torque Adapter

1 Nm = 0.738 ft.lb. = 0.102 kgf.m
 1 ft.lb. = 1.356 Nm = 0.138 kgf.m
 1 in.lb. = 0.113 Nm = 1.152 kgf.cm

34207-1A

34307-1A

34407-1A

• Specifications:

Accuracy	± 2%
Memory	50
Display Resolution	0.1 Nm /ft.lb. ,0.01 kgf.m
Operation Mode	Peak/Trace
Unit Selection	kgf.m , ft.lb. , Nm
Battery	AAA x 2 PC.
Battery Life	110hrs (continuous operation)
Operating Ambient Temperature	-10°C - 60°C (13.9°F - 139.9°F)
Storage Temperature	-20°C - 70°C (-4°F - 157.9°F)
Operating Relative Humidity	15 to 90% noncondensing
Switch off Automatically	70 seconds (if do not use electronic torque adapter.)
LED indicator	Green. Red
Overload Alarm	34207-1A: 37.5 Nm (27.6 ft.lb.) 34307-1A: 168.8 Nm(124.5 ft.lb.) 34407-1A: 250 Nm (184.4 ft.lb.)



Dual Scale - English & Newton Meter (ft.lb. & Nm / kg.m)

KT NO.	Square drive	Torque range			Size mm	Scales	Boxes
		Nm	ft.lb.	kgf.m			
34207-1A	1/4"	6-30 Nm	4.4-22.1 ft.lb.	0.61-3.06 kgf.m	L75 x W45 x H40	124	12 / 48
34307-1A	3/8"	27-135 Nm	19.9-99.6 ft.lb.	2.75-13.76 kgf.m	L75 x W45 x H40	198	12 / 48
34407-1A	1/2"	40-200 Nm	29.5-147.5 ft.lb.	4.08-20.38 kgf.m	L75 x W45 x H40	198.5	12 / 48

34407T-1A

new

Accuracy	± 2%
Memory	50
Display Resolution	0.1 Nm /ft.lb. ,0.01 kgf.m 1Psi /0.001 Bar /0.001 kgf-cm ² /0.01 Kpa
Operation Mode	Peak/Trace
Unit Selection	kg-cm, kg-m, lb-in, lb-ft, N-m Kpa, bar, psi, kg-cm ²
Battery	AAA x 2 PC.
Battery Life	50hrs (continuous operation)
Operating Ambient Temperature	-10°C - 60°C (13.9°F - 139.9°F)
Storage Temperature	-20°C - 70°C (-4°F - 157.9°F)
Operating Relative Humidity	15 to 90% noncondensing
Auto shut off	60 seconds



Dual Scale - English & Newton Meter (ft.lb. & Nm / kg.m)

KT NO.	Square drive	Torque range			Pressure range	Size mm	Scales	Boxes
		Nm	ft.lb.	kgf.m				
34407T-1A	1/2"	40-200	29.5-147.5 ft.lb.	4.08-20.38 kgf.m	1-100 psi (0.069-6.6bar)	L75 x W67 x H46 mm	343	1 / 24

Electronic Torque Adapter

1 Nm = 0.738 ft.lb. = 0.102 kgf.m
 1 ft.lb. = 1.356 Nm = 0.138 kgf.m
 1 in.lb. = 0.113 Nm = 1.152 kgf.cm

34607-1A

Specifications:

Accuracy	± 2%
Memory	50
Display Resolution	0.1 Nm / ft.lb. , 0.01 kgf.m
Operation Mode	Peak/Trace
Unit Selection	kgf.m , ft.lb. , Nm
Battery	AA x 2 PC.
Battery Life	110hrs (continuous operation)
Operating Ambient Temperature	-10°C - 60°C (13.9°F - 139.9°F)
Storage Temperature	-20°C - 70°C (-4°F - 157.9°F)
Operating Relative Humidity	15 to 90% noncondensing
Switch off Automatically	70 seconds (if do not use electronic torque adapter.)
LED indicator	Green. Red
Overload Alarm	1250 Nm (922 ft.lb.)

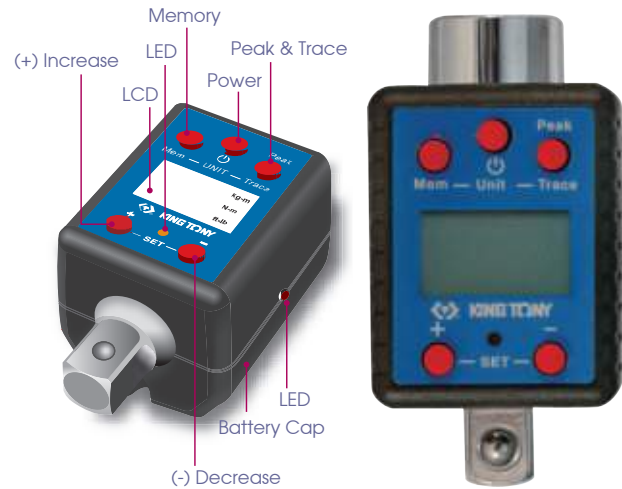

Dual Scale - English & Newton Meter (ft.lb. & Nm / kg.m)

KT NO.	Square drive	Torque range			Size mm	Scales	Pkg
		Nm	ft.lb.	kgf.m			
34607-1A	3/4"	200 ~1000 Nm	147.6~738 ft.lb.	20.4~102 kgf.m	L110 x W56 x H60	585	6 / 24



1. Do not press "M" and "⏻" button together otherwise system will enter in calibration mode.
2. Switch off the power after use.



Torque Screwdriver

34111

- Suitable for 1/4" Hex insert bit; 1/4" socket
- Automatic adjustment knob design
- Easy-to-read laser scale
- Ergonomic comfort rubber grip
- Tolerance of torque $\pm 5\%$ quality meets DIN ISO 6789:2017 & ASME B107.300-2010

1 Nm = 0.738 ft.lb. = 0.102 kgf.m
 1 ft.lb. = 1.356 Nm = 0.138 kgf.m
 1 in.lb. = 0.113 Nm = 1.152 kgf.cm



Tolerance of torque within $\pm 5\%$ quality meets DIN ISO 6789:2017 & ASME B107.300-2010

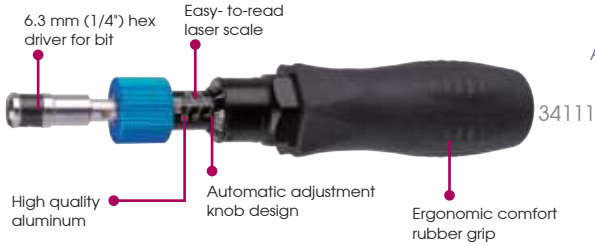

Aluminum alloy



KT NO.	1/4"DR.	Torque range cNm / Nm / in-lb	Incr.	Overall length mm		
34111-1DG		30~120 cNm	1 cNm	180	207	1 / 24
34111-1EG		3~15 in-lb	0.1 in-lb	180	207	1 / 24
34111-2DG		1.5~6.5 Nm	0.1 Nm	196	475	1 / 24
34111-2EG		10~50 in-lb	0.5 in-lb	196	475	1 / 24
34211-3DG		4~9 Nm	0.1 Nm	196	475	1 / 24

Torque Angle Gauge

34440

34440A

34660

34660A

- Square Drive :
 34440 (1/2" x 1/2")
 34660 (3/4" x 3/4")
- 360° angle scale- clearly marked in 2° increments, and in intervals of 10° and 30°
- Indicator etched on clear plastic plate, protects angle scale from dirt and grease
- Adjustable arm keeps angle scale stationary
- Arm has two lengths for additional flexibility in placement against components
- Tough composite dial and rotating index allowing operator to accurately tighten meeting to standard



KT NO.	Spec.		
34440	1/2"Fx1/2"M	190	12 / 48
34440A	1/2"Fx1/2"M	375	6 / 24
34660	3/4"Fx3/4"M	666	6 / 12
34660A	3/4"Fx3/4"M	908	6 / 12

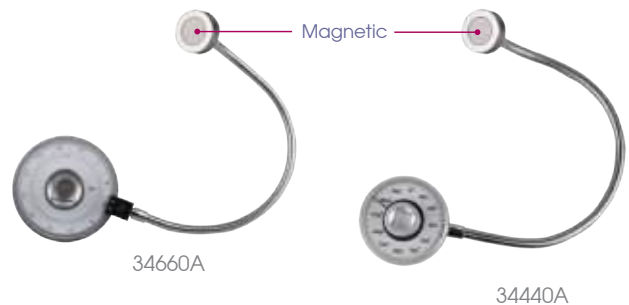

- Step 1: Set up the torque value by torque wrench
- Step 2: Adjust the angle by angle gauge

Torque Multiplier



Don't use pneumatic tool together with the multiplier.

34486

34488

34688

- Torque multiplication with 5:1, accuracy guaranteed better than $\pm 5\%$
- Reaction bar supplied in two styles for maximum versatility
- Ideal construction offers minimal maintenance and extended life
- Portable package brings convenience for use in different working places

1 Nm = 0.738 ft.lb. = 0.102 kgf.m
 1 ft.lb. = 1.356 Nm = 0.138 kgf.m
 1 in.lb. = 0.113 Nm = 1.152 kgf.cm

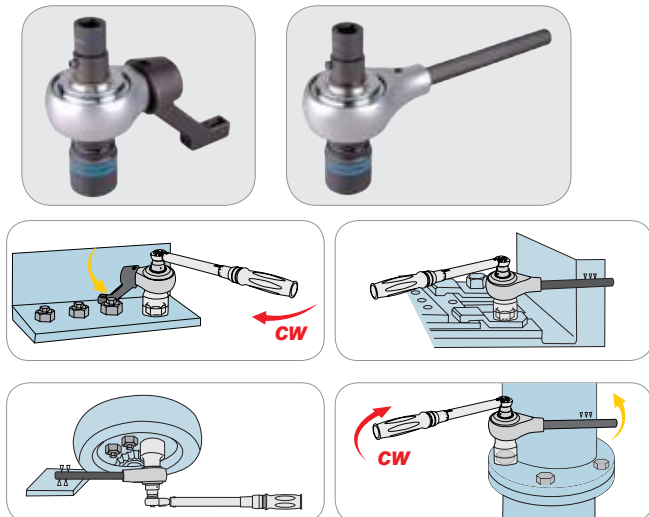

Contents

	34486-05A 34488-05A 34688-05A	Multiplier head 1 PC.
	34688-P01	Reaction bar 1 PC.
	34688-P02	Reaction bar 1 PC.
	34486-P03 34488-P03 34688-P03	Safety Break-Away Adapter 1 PC.

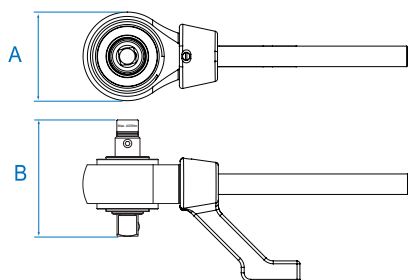

KT NO.	Ratio	Input square	Output square	Max input torque Nm / Ft.lb	Max output torque Nm / Ft.lb	A mm	B mm	kg	kg	kg
34486	5:1	1/2"	3/4"	300 / 220	1500 / 1100	108	140.3	7.1	1 / 2	
34488	5:1	1/2"	1"	400 / 290	2000 / 1450	108	136.3	7.5	1 / 2	
34688	5:1	3/4"	1"	540 / 400	2700 / 2000	108	161.0	7.7	1 / 2	



Torque Multiplier



Don't use pneumatic tool together with the multiplier.

34488-26

- Torque multiplication with 26:1, accuracy guaranteed better than $\pm 5\%$
- Reaction bar supplied in two styles for maximum versatility
- High ratios offers an idea to replace long lever arm and heavy wrench
- Ideal construction offers minimal maintenance and extended life
- Portable package brings convenience for use in different working places
- Anti-backlash device



Contents



Multiplier head 1 PC.



Reaction bar 2 PC.



KT NO.	Ratio	Input square	Output square	Max input torque Nm / Ft.lb	Max output torque Nm / Ft.lb		
34488-26	26:1	1/2"	1"	175 / 130	4500 / 3300	15.7	1 / 1





Universal Torque Converter Set

3488A03MP



- It is a newly designed wheel wrench for truck tires or car tires by using less labor to reach a sufficient output torque
- Suitable for trucks, buses, and other heavy duty vehicles

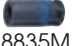

Contents

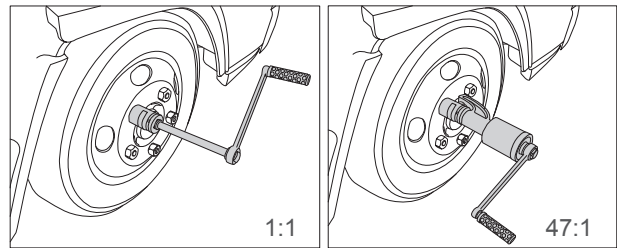
	Power Enhanced Device 1 PC.
	Prolonged Pole 1 PC.
	Handle 1 PC.
	32, 33



KT NO.	Ratio	Input square	Output square	Max input torque Nm / Ft.lb		
3488A03MP	47:1	1"	1"	4700 / 3466	9.3	1 / 2



Torque Tester

ZV011

Specifications:

7.7  1/1 

Calibration range	2~60 Nm
Accuracy	±0.5%
Units of measurement	Lb-in, Lb-ft, Kg-m, Kg-cm, N-m, N-cm
Input Hex A/F (mm)	10mm
Square Drive Adaptor (inch)	1/4", 3/8", 1/2"
Operating Temperature Range	+5°C~ +40°C
Storage Temperature Range	+0°C~ +70°C
Power Input	100-240V DC9.0V±1.66A, 15W MAX
Base material/ Finish	Aluminum Alloy / Painting
Dimension	210(L) x 150(W) x 140(H) mm

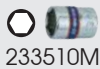

233510M



333510M



433510MR



ZV011A  Europe

ZV011B  America & Asia

ZV011D  Australia & New Zealand

ZV012

Specifications:

8.1  1/1 

Calibration range	8~400 Nm
Accuracy	±0.5%
Units of measurement	Lb-in, Lb-ft, Kg-m, Kg-cm, N-m, N-cm
Input Hex A/F (mm)	22mm
Square Drive Adaptor (inch)	3/8", 1/2", 3/4"
Operating Temperature Range	+5°C~ +40°C
Storage Temperature Range	+0°C~ +70°C
Power Input	100-240V DC9.0V±1.66A, 15W MAX
Base material/ Finish	Aluminum Alloy / Painting
Dimension	210(L) x 150(W) x 140(H) mm



333522M



433522MR



633522M



ZV012A  Europe

ZV012B  America & Asia

ZV012D  Australia & New Zealand

ZV013

Specifications:

8.9  1/1 

Calibration range	100~1500 Nm
Accuracy	±0.5%
Units of measurement	Lb-in, Lb-ft, Kg-m, Kg-cm, N-m
Input Hex A/F (mm)	36mm
Square Drive Adaptor (inch)	3/4"
Operating Temperature Range	+5°C~ +40°C
Storage Temperature Range	+0°C~ +70°C
Power Input	100-240V DC9.0V±1.66A, 15W MAX
Base material/ Finish	Aluminum Alloy / Painting
Dimension	210(L) x 150(W) x 140(H) mm



633536M



ZV013A  Europe

ZV013B  America & Asia

ZV013D  Australia & New Zealand

Notes



A series of horizontal dashed lines for writing notes, filling most of the page.